

CATALOG #	TYPE	
JOB NAME	WATTAGE	VOLTAGE

# SmartLED™ MRI Lighting System

## 4" RGBW Lensed Wall Wash

Create a patient-centric MRI experience with soothing, dynamic color scenes • Type IC

### Specifications

#### Delivered System Performance

- Nominal lumens: **-750L**; see photometric data for specific color lumens
- Quad chip RGBW
- Fully sustainable: removable for servicing
- Center beam optics positioned at 20°

#### Thermal Management System

- Aluminum heat sink and components for cool operation, long life, and low maintenance

#### SmartLED™ MRI Lighting System Required

- Kirlin DMX remote driver modules, cabinet, and RFI filters required for operation
- Components ordered separately, see [MRI-DMXPS](#)

#### SmartLED™ Emergency Backup System

- [EMI-21220](#) or [EMI-03120](#) available for emergency power
- See specification sheet; order separately

#### Trim and Lens Assembly

- White enamel self-flanged, low glare cone with lens above
- Optional colors and finishes available

#### Acrylic Enameled Aluminum Housing

- Rustproof and corrosion resistant: exceeds 1000 hour ASTM 5% salt spray test; all components fully sustainable
- Shallow depth for restricted plenums
- Cool operation extends component life
- Modular design; visible and fully serviceable through aperture
- Built-in plaster flange

#### Color & Controls

- Quad chip RGBW LEDs provide rich color palette for full spectrum expression
- DMX control via Kirlin DMX wall panel [MRI-DMXWP](#)
- Wall panel ships preloaded with standard scene configuration and presets - consult factory for custom programs

# MRR-04318

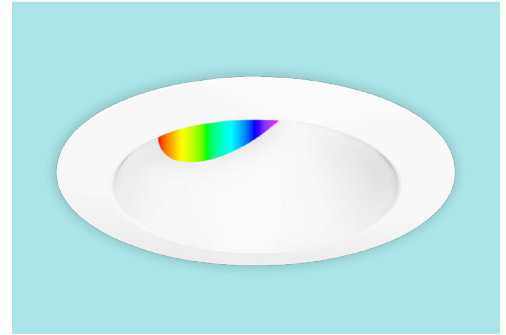

#### Installation & Hardware

- Requires minimum 18 AWG twisted pair shielded wire from SmartLED MRI driver modules, to filter, and included 35' RJ-45 cable from filter to luminaire
- Recesses in ceilings up to 1-1/8" thick
- Aluminum 27" hanger bars with adjustable mounting brackets (2) supplied.

#### UL, C-UL (Canada) Listings

- Wet, damp or dry locations, covered ceilings
- Type IC: for direct contact with insulation

#### IEC & FCC Compliance

- FCC Part 15 certified for EMI/RFI emissions

#### FIVE YEAR Limited Warranty

- Complete fixture, must be installed with all SmartLED™ components

## Options and Ordering Configuration

(Example: MRR-04318-1500L-RGB4-BGT)



Must Specify			Optional	
Model	Lumens	CCT & CRI	Trim & Lens Options	Other Options
MRR-04318				
	-750L	-RGB4: RGB + 4000K 80+ CRI	<p><b>(Blank):</b> All white acrylic enameled cone</p> <p><b>Trim Finishes</b></p> <p>-94: Custom color; consult factory</p> <p>-BGT: BioGard™ anti-microbial white</p> <p><b>Other Trim Features</b></p> <p>-32: White trim extender, specify OD</p> <p>-45: Gasket between trim flange and ceiling</p> <p><b>Lens Options</b></p> <p>-LL: Tempered glass lens converts beam to oval</p>	<p><b>(Blank):</b> None</p> <p><b>Mounting</b></p> <p>-79: Extension collar; ceilings up to 2" thick</p> <p><b>Other Options</b></p> <p>-99: Special modification; consult factory</p>

## Dimensions

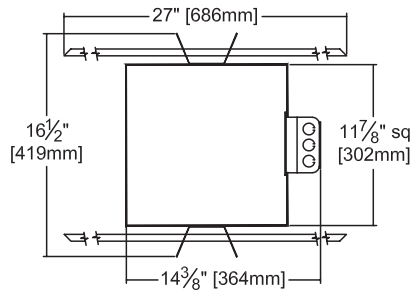
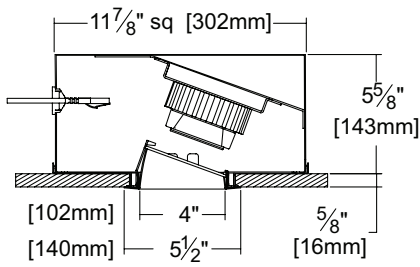

**Ceiling Cut-out**  
5" Dia.

## Photometry - Installed Complete Fixture

Photometry from I.T.L., Boulder, CO

LM-79 IESNA Certified Photometry from Independent Lab



**Lumens:**  
**LPW:**  
**ITL Test:**

**-750L**

**TESTING UNDERWAY**

WALL > --- 0°  
 --- 90°  
 --- 180°

\*LED manufacturers maintain a tolerance of +/-7% on flux (lumens) and power (electrical) measurements.

LIMITED WARRANTY: CATALOGED KIRLIN FIXTURES ARE WARRANTED FREE OF DEFECTS IN WORKMANSHIP OR MATERIAL FOR FIVE YEARS FROM DATE OF PURCHASE. INSTALLED TO N.E.C. IN NORMAL USE. Manufacturer at his option will replace or repair such fixture or refund the purchase price on presentation of proof of purchase and defective fixture at the offices of manufacturer within the years of original shipment. Liability of manufacturer is limited to the foregoing and manufacturer shall not be liable for any other damages, direct or indirect, sustained or suffered by purchaser or any person. This warranty is applied to the buyer in place of all other warranties, expressed or implied. Seller does not warrant as to merchantability or fitness for a particular use, nor will any oral statement constitute a warranty or amend this specific warranty. Abnormal use, abuse of the fixture, improper installation, or repair or modification of the fixture without prior written authorization from the manufacturer will render the warranty void.

