

Church, Shopping Mall, Office Q250 Downlights

Features

Lamp

- Designed for:
 - 1 vertical Q250 (max.) frosted tungsten halogen T-4.
- Double contact bayonet (DCB) base.
- Rated 2000 hour life; 100 CRI.
- Dimmable (controls by others).

Lampholder

- Double contact bayonet; heat resistant.
- Lamp socket bracket designed as heat sink.

Reflectors

- Upper: Specular Alzak® aluminum reflector for precise control of source.
- Lower: Low brightness clear specular parabolic Alzak aluminum cone, self-flanged.
- Eleven optional self-flanged cone colors and finishes available. See Options.
- Convection and radiation cooling by design.

Lens

- RR30714: Tempered MicroLux (microprismatic) lens mounted to upper reflector (0.5 S/MH). Optional tempered C#73 prismatic glass (Option -15 with 0.7

S/MH) or tempered clear glass (Option -28 with 0.2 S/MH) available.

- RR30715: Tempered C#73 prismatic glass lens mounted to upper reflector (1.0 S/MH).

Housing

- Acrylic enameled 100% aluminum. Vented.
- Rustproof: Exceeds 1000 hour ASTM 5% salt spray test.
- Cool: Dissipates heat across entire surface area. Maximizes component life.
- Entire luminaire visible and serviceable from below through removable lower cone.
- Top access optional (see Option -TA).
- Built-in plaster frame. Also see Option -79.

Outlet Box

- Prewired 14GA (NEC) galvanized steel, UL listed. With removable insulated cover.
- 1/2" and 3/4" knockouts.

Installation

- 27" galvanized hanger bars supplied (2).
- Fully adjustable universal galvanized mounting brackets supplied (2). Accepts 3/4" or 1-1/4" lathers channel or 1/2" T.S. conduit.
- Recesses indoors or outdoor in covered ceilings.

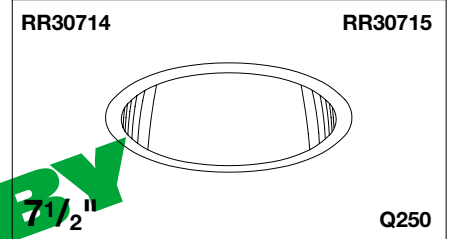

Four Distributions from Very Narrow to Wide
11 Optional Lower Cone Finishes

UL, C-UL (Canada) Listings

- Wet, damp or dry locations, covered ceilings.
- Through-branch circuit conductors (6 #12 AWG 90°C).

Three Year Limited Warranty

- Complete standard fixture.

Thermal Protection (Per Current NEC)

- Thermal protector included which provides automatic cut-off if rated temperature is exceeded. (Insulation related)

Performance at a Glance

RR30714

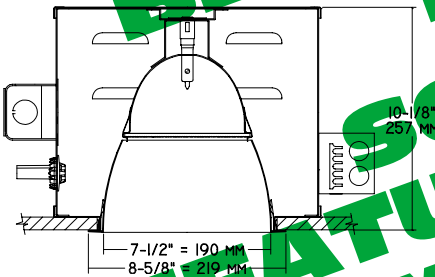

RR30715

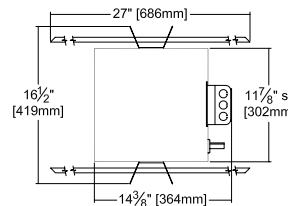
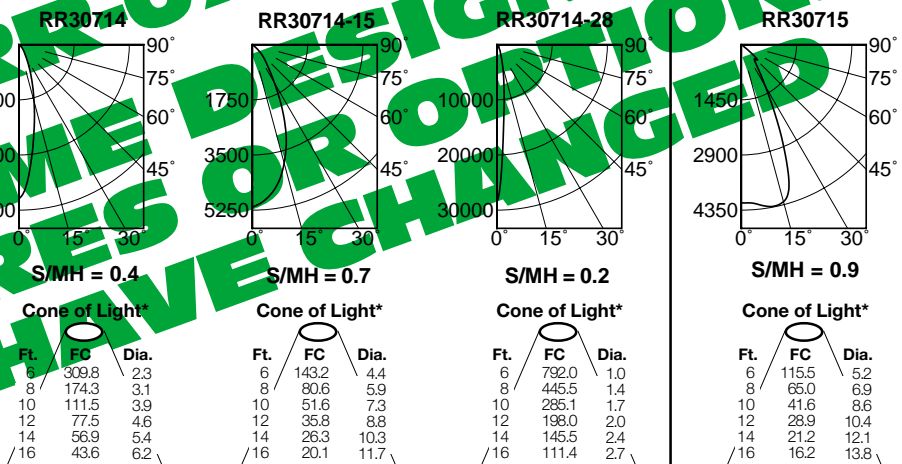
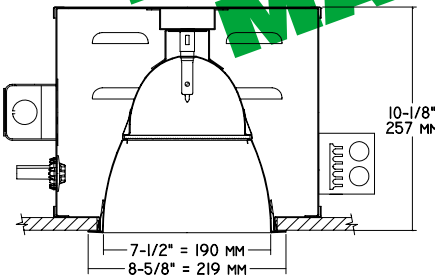

Cone of Light Key
Ft. Distance from fixture
FC Footcandles (average)
Dia. Circle of light at 50% of FC

* Dia. (in ft.) shown is where FC value is half the FC at nadir.

THE KIRLIN COMPANY

3401 EAST JEFFERSON AVENUE • DETROIT, MICHIGAN 48207-4232
(313) 259-6400 • Fax: (313) 259-9409 OR (313) 259-3121

**NEW MILLENNIUM
TUNGSTEN HALOGEN and
INCANDESCENT LIGHTING**

LAMP
**T-4
T-4**

MAXIMUM WATTAGE
**Q250
Q250**

CATALOG NUMBERS
**RR30714
RR30715**

RR30714
RR30715

RECESSED ROUND: Q250 WATT (MAX.) TUNGSTEN HALOGEN DOWNLIGHTS

KIRLIN

Detailed Photometry - Installed Fixture

FROM I.T.L. (BOULDER, CO)

RR30714: TEST NUMBER 55794
RR30714-28: TEST NUMBER 55793

RR30714-15: TEST NUMBER 55791
RR30715: TEST NUMBER 55392

RR30714

Efficiency = 72.2%

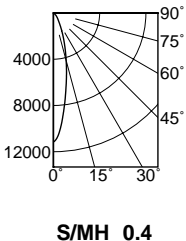

CANDLEPOWER DISTRIBUTION table with columns for beam angles and rows for fixture types.

COEFFICIENTS OF UTILIZATION table with columns for beam angles and rows for fixture types.

RR30714-15

Efficiency = 70.7%



CANDLEPOWER DISTRIBUTION table for RR30714-15.

COEFFICIENTS OF UTILIZATION table for RR30714-15.

RR30714-28

Efficiency = 74.6%

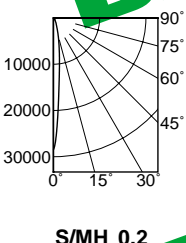

CANDLEPOWER DISTRIBUTION table for RR30714-28.

COEFFICIENTS OF UTILIZATION table for RR30714-28.

RR30715

Efficiency = 74.0%

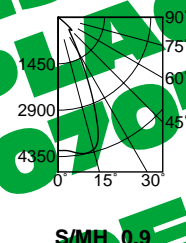

CANDLEPOWER DISTRIBUTION table for RR30715.

COEFFICIENTS OF UTILIZATION table for RR30715.

Estimated Multipliers

- 16 Champagne Gold Alzak® CP x .95
- 30 White: CP x .95
- 63 Dune Alzak: CP x .83

- 69 Wheat Alzak: CP x .93
- 70 Softex Clear: CP x .92
- 71 Softex Dune: CP x .89
- 72 Black Alzak: CP x .80

- 90 Softex Champagne Gold: CP x .90
- 91 Softex Wheat: CP x .85
- 93 Pewter Alzak: CP x .88
- OG Black OptiGroove: CP x .83

Options

- 15 Tempered prismatic C#73 glass lens for medium (0.7 S/MH) distribution. (RR30714 only)
- 16 Champagne Gold specular Alzak self-flanged lower cone. (CP x .95)
- 28 Tempered clear flat glass for narrowest (0.2 S/MH) distribution. (RR30714 only)
- 30 All white lower cone, self-flanged. (CP x .95)
- 31 White flange (only) on self-flanged lower cone.
- 32 Trim extender. Broadens trim flange O.D. by 1" to cover larger ceiling opening.
- 45 Gasket above reflector flange. Stops dust streaks on ceiling.
- 58 277/120V stepdown transformer for 277 volt

- line input, prewired into fixture.
- 63 Dune specular Alzak self-flanged lower cone. (CP x .93)
- 69 Wheat specular Alzak self-flanged lower cone. (CP x .92)
- 70 Softex Clear softly etched self-flanged lower cone. Resists smudges. (CP x .92)
- 71 Softex Dune softly etched self-flanged lower cone. Resists smudges. (CP x .89)
- 72 Black specular Alzak self-flanged lower cone. (CP x .80)
- 79 Extension collar for up to 2" thick ceilings.
- 82 Sloped ceiling adapter. Specify slope in 5° increments up to 30°.
- 90 Softex Champagne Gold softly etched self-flanged lower cone. Resists smudges. (CP x .90)

- 91 Softex Wheat softly etched self-flanged lower cone. Resists smudges. (CP x .88)
- 93 Pewter specular Alzak self-flanged lower cone. (CP x .88)
- 94 Specular or Softex custom color / finish lower cone, self-flanged. Consult factory.
- 99 Special modification. Consult factory.
- LP With frosted DCB lamp. Specify wattage and color temperature.
- OG OptiGroove black seamless tapered aluminum lower cone. White trim, self-flanged. (CP x .83)
- TA Top access modification for servicing from above.

SUBMITTAL DATA

APPROVAL STAMP

JOB NAME
TYPE
WATTAGE
CATALOG NUMBER

VOLTAGE

LIMITED WARRANTY: CATALOGUED KIRLIN FIXTURES ARE WARRANTED FREE OF DEFECTS IN WORKMANSHIP OR MATERIAL FOR THREE YEARS FROM DATE OF PURCHASE. INSTALLER SHALL BE RESPONSIBLE FOR PROPER INSTALLATION AND MAINTENANCE OF THE FIXTURE. THE WARRANTY IS VOID IF THE FIXTURE IS NOT INSTALLED OR MAINTAINED IN ACCORDANCE WITH THE INSTRUCTIONS PROVIDED WITH THE FIXTURE. THE WARRANTY IS VOID IF THE FIXTURE IS MODIFIED OR REPAIRED BY ANY OTHER PARTY. THE WARRANTY IS VOID IF THE FIXTURE IS USED IN AN UNUSUAL MANNER. THE WARRANTY IS VOID IF THE FIXTURE IS USED IN AN AREA WITH EXCESSIVE VIBRATION OR CORROSIVE ATMOSPHERE. THE WARRANTY IS VOID IF THE FIXTURE IS USED IN AN AREA WITH EXCESSIVE TEMPERATURE. THE WARRANTY IS VOID IF THE FIXTURE IS USED IN AN AREA WITH EXCESSIVE HUMIDITY. THE WARRANTY IS VOID IF THE FIXTURE IS USED IN AN AREA WITH EXCESSIVE SALINITY. THE WARRANTY IS VOID IF THE FIXTURE IS USED IN AN AREA WITH EXCESSIVE ACIDITY. THE WARRANTY IS VOID IF THE FIXTURE IS USED IN AN AREA WITH EXCESSIVE ALKALINITY. THE WARRANTY IS VOID IF THE FIXTURE IS USED IN AN AREA WITH EXCESSIVE OZONE. THE WARRANTY IS VOID IF THE FIXTURE IS USED IN AN AREA WITH EXCESSIVE ULTRAVIOLET RADIATION. THE WARRANTY IS VOID IF THE FIXTURE IS USED IN AN AREA WITH EXCESSIVE RADIOACTIVE RADIATION. THE WARRANTY IS VOID IF THE FIXTURE IS USED IN AN AREA WITH EXCESSIVE ELECTROMAGNETIC INTERFERENCE. THE WARRANTY IS VOID IF THE FIXTURE IS USED IN AN AREA WITH EXCESSIVE ELECTROSTATIC DISCHARGE. THE WARRANTY IS VOID IF THE FIXTURE IS USED IN AN AREA WITH EXCESSIVE MECHANICAL STRESS. THE WARRANTY IS VOID IF THE FIXTURE IS USED IN AN AREA WITH EXCESSIVE MECHANICAL VIBRATION. THE WARRANTY IS VOID IF THE FIXTURE IS USED IN AN AREA WITH EXCESSIVE MECHANICAL SHOCK. THE WARRANTY IS VOID IF THE FIXTURE IS USED IN AN AREA WITH EXCESSIVE MECHANICAL IMPACT. THE WARRANTY IS VOID IF THE FIXTURE IS USED IN AN AREA WITH EXCESSIVE MECHANICAL ABUSE. THE WARRANTY IS VOID IF THE FIXTURE IS USED IN AN AREA WITH EXCESSIVE MECHANICAL MISUSE. THE WARRANTY IS VOID IF THE FIXTURE IS USED IN AN AREA WITH EXCESSIVE MECHANICAL NEGLIGENCE. THE WARRANTY IS VOID IF THE FIXTURE IS USED IN AN AREA WITH EXCESSIVE MECHANICAL CARELESSNESS. THE WARRANTY IS VOID IF THE FIXTURE IS USED IN AN AREA WITH EXCESSIVE MECHANICAL RECKlessness. THE WARRANTY IS VOID IF THE FIXTURE IS USED IN AN AREA WITH EXCESSIVE MECHANICAL RASHNESS. THE WARRANTY IS VOID IF THE FIXTURE IS USED IN AN AREA WITH EXCESSIVE MECHANICAL IMPRUDENCE. THE WARRANTY IS VOID IF THE FIXTURE IS USED IN AN AREA WITH EXCESSIVE MECHANICAL FOLLY. THE WARRANTY IS VOID IF THE FIXTURE IS USED IN AN AREA WITH EXCESSIVE MECHANICAL STUPIDITY. THE WARRANTY IS VOID IF THE FIXTURE IS USED IN AN AREA WITH EXCESSIVE MECHANICAL IGNORANCE. THE WARRANTY IS VOID IF THE FIXTURE IS USED IN AN AREA WITH EXCESSIVE MECHANICAL OBSTINACY. THE WARRANTY IS VOID IF THE FIXTURE IS USED IN AN AREA WITH EXCESSIVE MECHANICAL PERSISTENCE. THE WARRANTY IS VOID IF THE FIXTURE IS USED IN AN AREA WITH EXCESSIVE MECHANICAL PERSEVERANCE. THE WARRANTY IS VOID IF THE FIXTURE IS USED IN AN AREA WITH EXCESSIVE MECHANICAL OBSTINACY. THE WARRANTY IS VOID IF THE FIXTURE IS USED IN AN AREA WITH EXCESSIVE MECHANICAL PERSISTENCE. THE WARRANTY IS VOID IF THE FIXTURE IS USED IN AN AREA WITH EXCESSIVE MECHANICAL PERSEVERANCE.