

CATALOG #	TYPE
JOB NAME	VOLTAGE

## Ligature & Vandal Resistant 6" LED Downlight

Type IC • Wet Location

1% Dimming • WFL • 3 CCT • 3-Step Binning

Integrated Module • LM-80 Qualified • LM-79 Certified

MRV-06857-2000L  
MRV-06857-1500L  
MRV-06857-1100L



4" Lens Aperture



See Option -SH for **Cleanroom Rated** Luminaire

### Specifications

#### Delivered System Performance\*

- Lumen Series: **MUST SPECIFY**
- 2000L: 2000 nominal lumens (20W).
- 1500L: 1500 nominal lumens (15W).
- 1100L: 1100 nominal lumens (11W).
- Distribution: WFL.
- Color temperature: 3500°K standard. Optional: -30K or -41K.
- CRI: 80+. Exceptionally consistent color.
- 50,000 hour life (L70\*\*).
- Fully sustainable: removable for servicing.

#### Thermal Management System

- All aluminum heat sink, components and housing maximize cool operation and long life while minimizing maintenance.

#### LED Power Supply - INTEGRAL

- 0-10V linear dimming standard. (100-1%)**
- 120-277V / 50-60Hz standard. Load insensitive.
- Suitable for outdoor / indoor use: -30°C (-22°F) to 60°C (140°F).

#### Trim / Lens Assembly

- Ligature resistant smooth white seamless tapered aluminum self-flanged rigid cast trim.
- Kirlin BioGard™ antimicrobial white finish continuously inhibits growth of bacteria on the coating of the trim.
- Flush center pin tamperproof hex screws and captive nuts secure trim to housing. Tamperproof tool included.
- High strength prismatic acrylic above .220" clear flat polycarbonate lens. Also see -DA.
- Continuous ring secures lens to trim.

#### Shallow 4¼" Aluminum Housing

- Rustproof and corrosion resistant: Exceeds 1000 hour ASTM 5% salt spray test.
- Shallow depth fits restricted plenums.
- Cool operation: Extends life of all components.
- Entire luminaire is modular, easily visible and serviced through aperture.
- Built-in plaster flange.

#### Outlet Box

- UL listed J-box with insulated removable cover. Prewired 14 GA (NEC) with ½" and ¾" knockouts.

**LEVEL 1+  
INFECTION  
PROTECTION**

#### Installation

- Recesses indoor/outdoor in covered locations.
- Accommodates ceilings up to 1-1/8" thick.
- 27" galvanized hanger bars with adjustable mounting brackets (2) supplied.

#### UL, C-UL (Canada) Listings

- Wet, damp or dry locations, covered ceilings.
- Type IC: for direct contact with insulation.
- Through-branch conductors (4 #12 AWG 90°C) for Type IC Listing.

#### IEC & FCC Compliance

- Meets IEC/EN 60601-1-2 electromagnetic compatibility standard for medical electrical equipment.
- FCC Part 15 certified for EMI/RFI emissions.



**FIVE YEAR  
Limited Warranty**

- Complete standard fixture.

MUST SPECIFY	OPTIONAL	Ordering Example: <b>MRV-06857-2000L-30K-DA</b>
Product Number	Options	
<b>MRV-06857-2000L</b> <b>MRV-06857-1500L</b> <b>MRV-06857-1100L</b>	See "Options" below	

### Options

#### LED Power Supply

- EI REMOTE emergency inverter for 100% of rated lumens. Run time: 90+ minutes. 120 or 277V, 60Hz input only. Specify voltage. Not for use with Option -FS.

Projected L70** for Kirlin Luminaires	
In Open Plenum	50,000 hours
In Insulation (Type IC)	50,000 hours

\*\*Hours at 70% lumen maintenance

#### Color (CCT)

- 30K Color temperature 3000°K instead.
- 41K Color temperature 4100°K instead.

#### Lens and Trim

- 35T Natural aluminum (silver) acrylic enameled trim. (non BioGard™)
- 94 Custom color/finish. Specify. (non BioGard™) Consult factory.
- BN Brushed nickel cast trim instead. (non BioGard™)
- CF Custom color filter (Rosco). Specify.

- DA Diffuse acrylic lens above poly instead of prismatic acrylic. -WFL only.
- I66 IP66 rated trim. Also see Option -SH.

#### Other

- 99 Special modification. Consult factory.
- FS Single in-line fuse. Not for use with Option -EI.
- SH Sealed housing and junction box. Provides Cleanroom Rated luminaire. (ISO 5 Class 100) Must be used with Option -IP. **NOTE: Housing depth increases to 5.66".**

# MRV-06857-2000L

## PERFORMANCE



## Dimensions

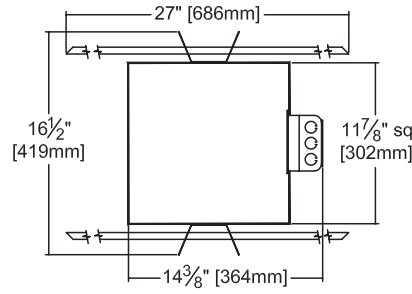
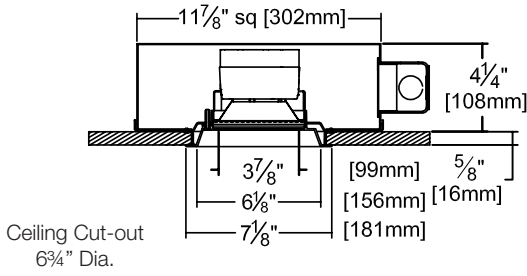

## Detailed Photometry - Installed Fixture

Photometric testing done in accordance with IESNA LM-79

Photometry from I.T.L., Boulder, CO

### -2000L STANDARD (WFL)

Lumens: 1555  
 Beam: ~57°  
 SC: 1.1  
 LPW: 77  
 Efficiency: 77.8%  
 ITL Test: 90896

Cone of Light ▲

Dist.	FC	Dia.
6	21.8	6.4
8	12.3	8.6
10	7.8	10.7
12	5.4	12.9
14	4.0	15.0
16	3.1	17.2

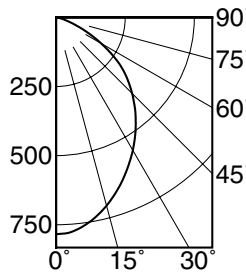

Total System Watts 20.3

	CANDLEPOWER DISTRIBUTION				
	0.0	22.5	45.0	67.5	90.0
0	784	784	784	784	784
5	774	774	774	774	774
15	705	705	705	705	705
25	607	607	607	607	607
35	501	501	501	501	501
45	389	389	389	389	389
55	265	265	265	265	265
65	118	118	118	118	118
75	28	28	28	28	28
85	6	6	6	6	6
90	0	0	0	0	0

LUMEN SERIES	LUMEN FACTOR	WATTAGE FACTOR	LPW FACTOR
-1500L	0.75	0.75	1.00
-1100L	0.55	0.55	1.00

### LM-80 Qualified • LM-79 Certified Photometry

\* LED manufacturers maintain a tolerance of ±7% on flux (lumens) and power (electrical) measurements. Kirlin photometrics are actual test data from Independent Testing Laboratories (ITL) where photometry was measured from 2000 (-2000L) light engines (within the established tolerance).

#### ▲ Cone of Light Key

Dia. (in ft.) shown is where FC value is half the FC at nadir.

Dist. Distance (Ft.) from fixture

FC Footcandles at nadir (0°)  
 Dia. Circle of light at 50% of FC

## SUBMITTAL DATA

JOB NAME

TYPE

VOLTAGE

CATALOG NUMBER

## APPROVAL STAMP



LIMITED WARRANTY: CATALOGED KIRLIN FIXTURES ARE WARRANTED FREE OF DEFECTS IN WORKMANSHIP OR MATERIAL FOR FIVE YEARS FROM DATE OF PURCHASE. INSTALLATION TO N.E.C. IN NORMAL USE. Manufacturer at the option will replace or repair such fixture or refund the purchase price on presentation of proof of purchase and defective fixture to the office of manufacturer within five years of original shipment. Liability of manufacturer is limited to the reshipping, and manufacturer shall not be liable for any other damages, direct or indirect, sustained or suffered by purchaser or any person. This warranty is supplied to the buyer in place of all other warranties, expressed or implied. Seller does not warrant as to merchantability or fitness for a particular use, nor will any oral statement constitute a warranty or amend this specific warranty. Abnormal use, abuse of the fixture, improper installation, or repair or modification of the fixture without prior written authorization from the manufacturer will render the warranty void.