

CATALOG #	TYPE
JOB NAME	VOLTAGE

## Clean Room • 6" LED Downlight

White IP66 Rated Trim • Type IC • Wet Location  
 10% Dimming • WFL • 5 CCT • 3-Step Binning  
 Up to 90,000 Hour Life • LM-80 Qualified • LM-79 Certified



MRR-06866-2000L  
 MRR-06866-1500L  
 MRR-06866-1000L  
 MRR-06866-500L



4" Lens Aperture



### Specifications

#### Delivered System Performance\*

- Lumen Series: **MUST SPECIFY**
  - 2000L: 2000 nominal lumens (25W).
  - 1500L: 1500 nominal lumens (20W).
  - 1000L: 1000 nominal lumens (11W).
  - 500L: 500 nominal lumens (5W).
- Distribution: WFL standard.  
Optional: -MFL.
- Color temperature: 3500°K standard.  
Optional: -27K, -30K, -41K or 50K.
- CRI: 80+ standard. Optional: -HC (90+).
- 90,000 hour life (L70).
- Fully sustainable: removable for servicing.

#### Thermal Management System

- All aluminum heat sink, components and housing maximize cool operation and long life while minimizing maintenance.

#### LED Power Supply - INTERNAL

- 0-10V CCR dimming standard. (100-10%)**
- 120-277V / 50-60Hz standard. Load insensitive.
- Suitable for outdoor / indoor use:  
-30°C (-22°F) to 60°C (140°F).

#### Trim / Lens Assembly

- Smooth white seamless tapered aluminum self-flanged rigid cast trim.
- Kirlin BioGard™ antimicrobial white finish continuously inhibits growth of bacteria on the coating of the trim.



Available - See Options

- High strength prismatic acrylic above .125" clear flat polycarbonate lens.
- Vandal and ligature resistant, see Option -25.
- IP66 Sealed and Gasketed - Clean Room**
- Silicone seal between trim and lens seals lens to trim.
- Closed cell gasketing on trim flange seals flange to ceiling.
- O-rings on stainless steel fasteners seal fasteners to trim.
- ISO 5 / Class 100 Sealed Clean Room rated.

#### Acrylic Enameled Aluminum Housing

- Air tight housing and junction box. Meets/exceeds ASTM E283 restricted airflow of 2 CFM maximum. CCEA approved.
- ISO 5 / Class 100 Sealed Clean Room rated.
- Rustproof and corrosion resistant: Exceeds 1000-hour ASTM 5% salt spray test.
- Shallow depth fits restricted plenums.
- Cool operation: Extends life of all components.
- Entire luminaire, including light engine, is modular, easily visible, serviced through aperture. Built-in plaster flange.

#### Outlet Box

- UL listed J-box with insulated removable cover. Prewired 14 GA (NEC) with 1/2" and 3/4" knockouts.

#### Installation

- Recesses indoor/outdoor in covered locations.
- Accommodates ceilings up to 1-1/8" thick.
- 27" galvanized hanger bars with adjustable mounting brackets (2) supplied.

#### UL, C-UL (Canada) Listings

- Wet, damp or dry locations, covered ceilings.
- Type IC: for direct contact with insulation.
- Through-branch conductors (4 #12 AWG 90°C) for Type IC Listing.

#### IEC & FCC Compliance

- Meets IEC/EN 60601-1-2 electromagnetic compatibility standard for medical electrical equipment.
- FCC Part 15 certified for EMI/RFI emissions.



**FIVE YEAR Limited Warranty**

- Complete standard fixture.

MUST SPECIFY		OPTIONAL	Ordering Example: <b>MRR-06866-2000L-120-30K-WFL</b>
Product Number	Voltage	Options	
MRR-06866-2000L MRR-06866-1500L MRR-06866-1000L MRR-06866-500L	-120 (120 volts) -277 (277 volts) -97 (Specify other)	See "Options" below	

### Options

#### Input Power: SPECIFY

- 120 120V (50-60Hz) input.
- 277 277V (50-60Hz) input.
- 97 Specify other voltage. Consult factory.

#### LED Power Supply

- 29† **Two wire** full range (100-1%) PWM dimming instead (Lutron). Consult factory. 120V only. Not available with Option -EI.
- 39† **Three wire** full range (100-1%) PWM dimming instead (Lutron). Consult factory.
- D1† 0-10V 1.0% dimming instead.
- D2† 0-10V 0.1% dimming instead.
- D3† DALI 1.0% dimming instead.
- D4† DALI 0.1% dimming instead.
- D5† DMX512A 0% dimming instead.

- EI REMOTE emergency inverter for 100% of rated lumens. Run time: 90+ minutes. 120 or 277V, 60Hz input only. Specify voltage. Not for use with Option -29 or -FS.
- ERH REMOTE emergency battery pack. Delivers 1000 lumens. Run time: 90+ minutes. CEC Compliant.

#### Color (CCT and CRI)

- 27K Color temperature 2700°K instead.
- 30K Color temperature 3000°K instead.
- 41K Color temperature 4100°K instead.
- 50K Color temperature 5000°K instead.
- HC 90+ CRI instead. Consult factory.

Projected L70** for Kirlin Luminaires	
In Open Plenum	90,000 hours
In Insulation (Type IC)	60,000 hours

\*\*Hours at 70% lumen maintenance

#### Optics

- MFL Medium flood distribution instead.

#### Lens and Trim

- 25 Vandal resistant trim, hardware and lensing. Provides ligature and vandal resistance.
- 35T Natural aluminum (silver) acrylic enameled trim. (non BioGard™)
- 94 Custom color/finish. Specify. (non BioGard™) Consult factory.
- BN Brushed nickel cast trim instead. (non BioGard™)
- CF Custom color filter (Rosco). Specify.
- GE Green acrylic filter mounted in lens assembly.
- WA White acrylic (flat) diffuser instead.

#### Other

- 99 Special modification. Consult factory.
- FS Single in-line fuse. Not for use with Option -EI.

**Dimensions**

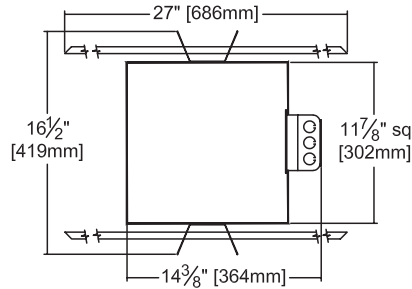
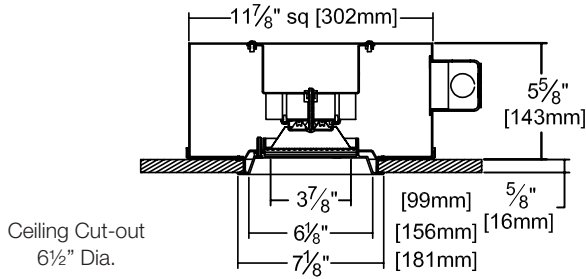

**Detailed Photometry - Installed Fixture**

Photometric testing done in accordance with IESNA LM-79

Photometry from I.T.L., Boulder, CO

THIS PRODUCT HAS BEEN UNDERWAY PHOTOMETRIC TESTING RENUMBERED PLEASE SEE MRR-06848

**LM-80 Qualified • LM-79 Certified Photometry**

\* LED manufacturers maintain a tolerance of ±7% on flux (lumens) and power (electrical) measurements. Kirlin photometrics are actual test data from Independent Testing Laboratories (ITL) where photometry was measured from 2000 lumen (-2000L) light engines (within the established tolerance).

**SUBMITTAL DATA**

JOB NAME  
  
TYPE VOLTAGE  
  
CATALOG NUMBER

**APPROVAL STAMP**



LIMITED WARRANTY: CATALOGED KIRLIN FIXTURES ARE WARRANTED FREE OF DEFECTS IN WORKMANSHIP OR MATERIAL FOR FIVE YEARS FROM DATE OF PURCHASE. INSTALLED TO N.E.C. IN NORMAL USE. Manufacturer at the option will replace or repair such fixture or refund the purchase price on presentation of proof of purchase and defective fixture at the office of manufacturer within five years of original shipment. Liability of manufacturer is limited to the foregoing, and manufacturer shall not be liable for any other damages, direct or indirect, sustained or suffered by purchaser or any person. This warranty is supplied to the buyer in place of all other warranties, expressed or implied. Seller does not warrant as to merchantability or fitness for a particular use, nor will any oral statement constitute a warranty or amend the specific warranty. Abnormal use, abuse of the fixture, improper installation, or repair or modification of the fixture without prior written authorization from the manufacturer will render the warranty void.