

CATALOG #	TYPE	
JOB NAME	WATTAGE	VOLTAGE

Lighting for Patient Spaces

Super Shallow Lensed 5" Downlight • LED

Up to 60,000 Hour Life • Type IC • Wet Location
LM-80 Qualified • LM-79 Certified Photometry

MRR-05825



Specifications

Delivered System Performance*

- Nominal Lumens: **Must Specify Type-IC -2500L**
- Select trim & beam distribution: WFL
- Select color (CCT): see chart; 80+ CRI standard; Option -HC for 90+ (15% lumen loss)
- 90,000 hour life (L70**)

Thermal Protection: SPECIFY VOLTAGE

- Thermal protector for insulation detection per UL/NEC. Must specify input voltage

Thermal Management System

- Aluminum heat sink and components for cool operation, long life, and low maintenance

LED Driver - INTERNAL

- Indoor/Outdoor: -30°C to 60°C (-22°F to 140°F)
- 0-10V CCR dimming standard (100-10%)
- Voltage Options: **Must Specify**
- 120:** -120V (50-60Hz); load insensitive
- 277:** -277V (50-60Hz); load insensitive

Trim Assembly - Fully Gasketed

- High efficiency reflector
- Frosted microprismatic tempered lens at ceiling; or see Options
- White flat seamless aluminum, one piece self-flanged trim (field paintable)

Acrylic Enameled Aluminum Housing

- Rustproof and corrosion resistant: exceeds 1000 hour ASTM 5% salt spray test; all components fully sustainable
- Shallow depth fits restricted plenums
- Cool operation extends component life
- Modular design; visible and fully serviceable through aperture
- Built-in plaster flange

Outlet Box (Galvanized)

- UL listed J-box with removable cover. Prewired 14 GA (NEC) with eight 1/2" knockouts

Installation & Hardware

- Indoor/outdoor in ceilings up to 1 1/8" thick

- Compatible with fire rated enclosures (by others)
- 27" galvanized hanger bars & adjusting brackets (2) supplied

UL, C-UL (Canada) Listings

- Wet, damp or dry locations, covered ceilings
- Type IC: for direct contact with insulation
- Through-branch conductors (4 #12 AWG 90°C) for Type IC listing

IEC & FCC Compliance

- Meets IEC/EN 60601-1-2 electromagnetic compatibility standard for medical electrical equipment

Options and Ordering Configuration

(Example: MRR-05825-2500L-120-41K-D1-38T)

Made in the USA

BioGard™
See Option -BG

FCC Part 15
Certified

UL Listed
Wet, Damp, Dry

Must Specify			Optional				
Model	Lumens	Volts	CCT & CRI	Driver Options	Emergency	Lens & Trim Options	Other Options
MRR-05825	-2500L	-120 -277 -97†: Other voltage	(Blank): 3500K, 80+ CRI 80+ CRI -27K: 2700°K -30K: 3000°K -35K: 3500°K -41K: 4100°K -50K: 5000°K 90+ CRI -27K-HC: 2700°K -30K-HC: 3000°K -35K-HC: 3500°K -41K-HC: 4100°K -50K-HC: 5000°K	(Blank): Standard 0-10V CCR 10% dim -D1: 0-10V 1.0% dim -ECO: Digital driver for Lutron EcoSystem controls. Dims to 1% or consult factory	(Blank): None -ERH: Remote emergency battery pack; delivers 1000 lumens; CEC Compliant; 90+ minutes	(Blank): White seamless aluminum trim Trim Finishes -35T: Silver enamel trim -37T: Dark bronze enamel trim -38T: Black enamel trim -94: Custom color; consult factory -BG: BioGard™ anti-microbial white Other Trim Features -17: Prismatic high strength acrylic lens instead -32: White trim extender, specify OD -33: Tempered glass Glow Ring suspended beneath trim; shape matches reflector -DF: Electrically isolated trim -WA: White acrylic (flat) diffuser instead; will produce wide flood distribution	(Blank): None -99: Special modification; consult factory -FS: Fused primary; One per fixture
		†Consult factory					

Dimensions

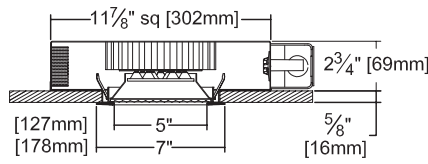

Ceiling Cut-out
6 1/2" Dia.

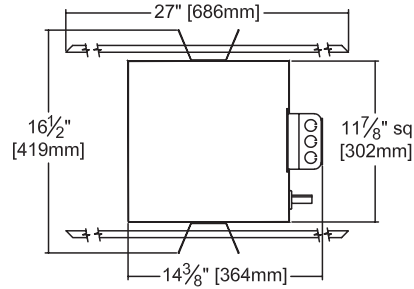

Photometry - Installed Complete Fixture

Photometry from I.T.L., Boulder, CO

LM-79 IESNA Certified Photometry from Independent Lab

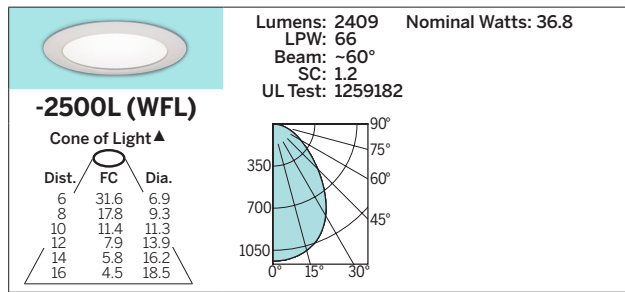

*LED manufacturers maintain a tolerance of +/-7% on flux (lumens) and power (electrical) measurements.

▲ **Cone of Light Key**
 Dia. (in ft.) shown is where FC value is half the FC at nadir.

Dist. Distance (Ft.) from fixture
FC Footcandles at nadir (0°)
Dia. Circle of light at 50% of FC

LIMITED WARRANTY: CATALOGED KIRLIN FIXTURES ARE WARRANTED FREE OF DEFECTS IN WORKMANSHIP OR MATERIAL FOR FIVE YEARS FROM DATE OF PURCHASE. INSTALLATION, IN-NORMAL USE, MANUFACTURER AT HIS OPTION WILL REPLACE OR REPAIR SUCH FIXTURE OR RETURN THE PURCHASE PRICE OR REPRESENTATION OF PROOF OF PURCHASE AND DEFECTIVE FIXTURE AT THE OFFICES OF MANUFACTURER WITHIN THE YEARS OF ORIGINAL SHIPMENT. LIABILITY OF MANUFACTURER IS LIMITED TO THE FOREGOING AND MANUFACTURER SHALL NOT BE LIABLE FOR ANY OTHER DAMAGES, DIRECT OR INDIRECT, SUSTAINED OR SUFFERED BY PURCHASER OR ANY PERSON. THIS WARRANTY IS APPLIED TO THE BUYER IN PLACE OF ALL OTHER WARRANTIES, EXPRESSED OR IMPLIED. SELLER DOES NOT WARRANT AS TO MERCHANTABILITY OR FITNESS FOR A PARTICULAR USE, NOR WILL ANY ORAL STATEMENT CONSTITUTE A WARRANTY OR AMEND THIS SPECIFIC WARRANTY. ABNORMAL USE, ABUSE OF THE FIXTURE, IMPROPER INSTALLATION, OR REPAIR OR MODIFICATION OF THE FIXTURE WITHOUT PRIOR WRITTEN AUTHORIZATION FROM THE MANUFACTURER WILL RENDER THE WARRANTY VOID.